



# CROFTS ESTATE AGENTS

PASSIONATE ABOUT PROPERTY

CLEETHORPES  
01472 200666

IMMINGHAM  
01469 564294

LOUTH  
01507 601550

SALES LETTINGS NEW HOME SALES LAND PROPERTY MANAGEMENT AUCTIONS FINANCIAL ADVICE AND MORTGAGES ENERGY PERFORMANCE PROVIDER



## Humberstone Road

Grimsby  
DN32 8DR

Offers in the Region Of  
£120,000

Crofts Estate Agents are delighted to be advertising this most beautifully presented and stylish three bedroom end of terrace property. This superb property gives first glance of the quality once you step into the spacious hallway. To the front of the property you will find the reception room with great living space. Next walking back through the hall, you enter into an open plan kitchen diner, with a modern and stylish fitted kitchen, which benefits from an integrated oven, hob and extractor fan, free standing fridge/freezer and washing machine. The first floor comprises two good sized double bedrooms and one single room, still of a good size and a refurbished spacious family bathroom. The property benefits from a private side patio area with artificial turf for ease of maintenance. Offering the benefits of gas central heating and uPVC double glazing throughout, viewings are highly recommended. This property is currently tenanted at £600 PCM however it would also be suitable for other buyers such as first time buyer etc.

CLEETHORPES: 62 St Peters Avenue, Cleethorpes, DN35 8HP

IMMINGHAM: 21 Kennedy Way, Immingham, DN40 2AB

LOUTH: 3 Market Place, Louth, LN11 9NR

Email: Cleethorpes:

Email: Immingham :

Email: Louth :

info@croftsestateagents.co.uk

immingham@croftsestateagents.co.uk

louth@croftsestateagents.co.uk

[www.croftsestateagents.co.uk](http://www.croftsestateagents.co.uk)





### Entrance Hallway

Located at the centre of the property and entered from the side elevation this lovely hallway has a bright and welcoming feel, comprising of neutral décor with feature library styled wooden panelling to the bottom half of the walls. Gas central heating radiator with cover. Down lighting to the ceiling. uPVC frosted door and window. This space also benefits from under stairs storage.

### Lounge

11' 10" x 14' 1" (3.6m x 4.3m)

This reception room is a nice sized living area and has been modernised and finished to a high standard. Comprising of neutral décor with library style wooden panelling to the bottom of the walls, and with neutral décor to the rest. Feature wall with open box storage. Down lighting to the ceiling. Gas central heating radiator. uPVC double glazed bay window to the front elevation.

### Kitchen Diner

26' 5" x 12' 9" (8.06m x 3.89m)

This extensive kitchen dining area is of an incredible 26ft providing plenty of space for dining and entertaining. Finished to a high standard the kitchen comprises of neutral décor with dark wooden panelled feature walls and fitted with a high quality laminate flooring. Wooden style worktops on top of a run of high gloss cream cupboards. The kitchen also benefits from an integrated electric oven and hob with extractor fan, washing machine, free standing fridge/freezer and space for a tumble dryer. uPVC bay window and

uPVC door and window to the side garden. Down lighting to the ceiling. Gas central heating radiator.

### First Floor Landing

Providing access to the bedrooms and bathroom.

### Bedroom One

14' 1" x 11' 3" (4.30m x 3.44m)

Neutrally decorated and having uPVC double glazed window to the front elevation. Central heating radiator.

### Bedroom Two

11' 0" x 10' 6" (3.36m x 3.21m)

uPVC double glazed window to the rear elevation. Central heating radiator.

### Bedroom Three

10' 7" x 8' 2" (3.22m x 2.48m)

uPVC double glazed window to the side elevation. Central heating radiator.

### Bathroom

6' 9" x 7' 4" (2.05m x 2.24m)

Modern bathroom with uPVC double glazed window and being fitted with a panelled bath with shower over, close coupled w.c and a wash hand basin. Tiled splashback. Central heating radiator.

### Outside

The property offers low maintenance gardens to the front and side elevations. The side garden has a wall and fenced perimeter with side gated access and has an artificial lawn.

### Tenure

Believed to be Freehold, awaiting solicitors' formal confirmation. All interested parties are advised to make their own enquiries.

### Services

All mains services are understood to be connected, however Crofts have not inspected or tested any of the services or service installations & purchasers should rely on their own survey.

### Viewings

Please contact the relevant marketing office, all viewings are strictly by appointment only please.

### Council Tax Information

Band A: To confirm council tax banding for this property please view the website [www.voa.gov.uk/cti](http://www.voa.gov.uk/cti)

### Free Valuations

We offer a free valuation with no obligation, just call the relevant office or visit [www.croftsestateagents.co.uk](http://www.croftsestateagents.co.uk) seven days a week to arrange for your free valuation.

### Property Management

We offer a full property management service, offering full and comprehensive credit and referencing checks detailed photographic inventories and regular property inspections to name just a few of our services.

### Mortgage and Financial Advice

With access to the whole of the mortgage markets, Crofts Estate Agents in connection with The Mortgage Advice Bureau will help you find the best mortgage to suit your needs. The Mortgage Advice Bureau will act on your behalf in advising you on mortgages and other financial matters

*STATUTORY NOTICE: YOUR HOMES IS AT RISK IF YOU DO NOT KEEP UP REPAYMENTS ON A MORTGAGE OR OTHER LOAN SECURED ON IT.*

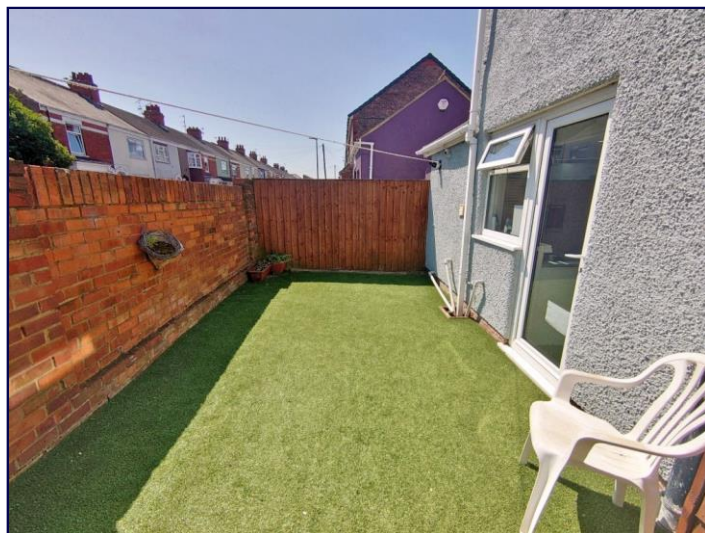

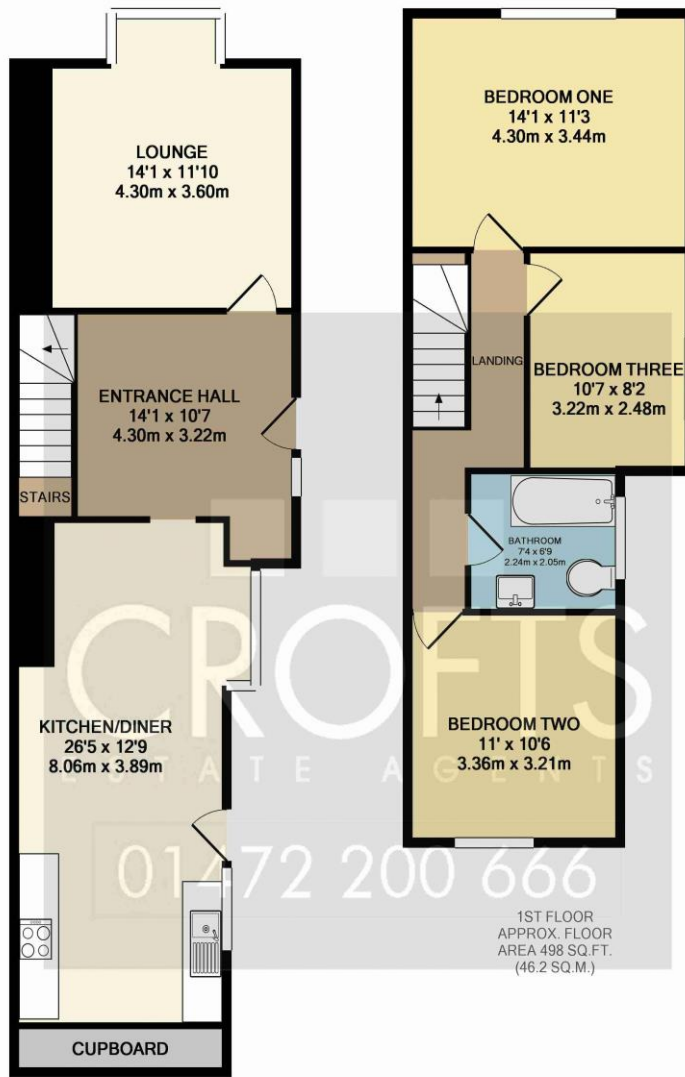

GROUND FLOOR  
APPROX. FLOOR  
AREA 581 SQ.FT.  
(53.9 SQ.M.)

TOTAL APPROX. FLOOR AREA 1078 SQ.FT. (100.2 SQ.M.)

Whilst every attempt has been made to ensure the accuracy of the floor plan contained here, measurements of doors, windows, rooms and any other items are approximate and no responsibility is taken for any error, omission, or mis-statement. This plan is for illustrative purposes only and should be used as such by any prospective purchaser. The services, systems and appliances shown have not been tested and no guarantee as to their operability or efficiency can be given  
Made with Metropix ©2015

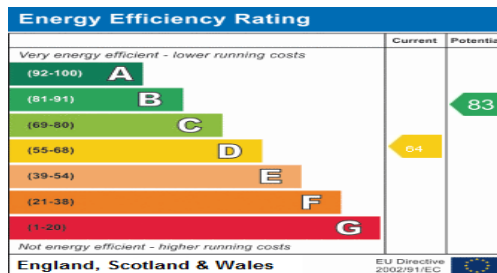

**DISCLAIMER - IMPORTANT NOTICE REGARDING SALES PARTICULARS** Although we have taken great care to insure the accuracy of the information contained in these particulars, we specifically deny liability for any mistakes, omissions or errors and strongly advise that all proposed purchasers should satisfy themselves by inspection or otherwise, as to their correctness, prior to entering into any commitment to purchase. In particular any information provided in respect of tenure, council tax, rateable values etc has been given in good faith and whilst believed to be correct, may be subject to amendment. Any references to the condition, use or appearance of the property are made for guidance only, and no warranties are given or implied by this information. It is not Crofts policy to check the position with regards to any planning permission or building regulation matters and as such all interested parties are advised to make their own enquires, in order to ensure that any necessary consents have been obtained. All measurements are approximate and are for guidance only and cannot be relied upon. Measurements are taken from wall to wall unless otherwise stated, with the metric conversion shown in brackets. Any plans or maps contained are for identification purpose only, and are not for any other use but guidance & illustration. Crofts have not tested any apparatus, equipment, fixtures, fittings or services including central heating systems and cannot therefore verify that they are in working order, or fit for their intended purpose. These details do not form any part of any contract, and unless specifically stated otherwise, furnishings and contents are not included within this sale.